

LEVELO



Levelo

VibeMaster Hybrid ANC Headphone

SKU: LVLVMAHPBK

Table of Contents

Features	2
Product Overview	2
A. Headset	2
B. Touchscreen	3
Power ON/OFF Instructions	3
Pairing Screen with Headset	4
Pairing Headset with Devices	5
Headset Button Guide	5
A. Music Playback Controls	5
B. Call Management	5
C. Siri Function	5
D. Clear Pairing	5
Headset ANC Mode	6
Headset AUX Mode	6
Touchscreen Operation Guide	6
Headset Indicator Light Guide	7
Charging	7
Specifications	8
Warranty	10
Contact Us	10

Before installing and using the product, please carefully read this User Manual to guarantee correct usage and keep it secure for future reference.

Features

- 1.** The Levelo headphone feature an ANC level of up to 40dB, with dual noise-detecting microphones that effectively filter up to 95 % of low-frequency ambient noise, ensuring an undisturbed listening experience.
- 2.** The headphones offer three distinct noise cancellation modes: Transport mode for minimizing travel noise, ANC mode for general noise reduction, and Normal mode for less intensive use.
- 3.** Crafted with ultra-soft protein leather and memory foam earcups, these headphones are designed to provide a snug and comfortable fit, making them ideal for prolonged listening sessions. Their lightweight construction further enhances overall comfort.
- 4.** Enjoy a customizable fit thanks to the headphones' rotatable, foldable, and stretchable design, which allows for easy adjustment and convenient storage.
- 5.** Experience superior sound quality with these headphones, designed to deliver an exceptional audio experience across various music genres.
- 6.** Tailor your audio experience with five available EQ settings: Normal for balanced sound, Rock to enhance guitar and drums, Pop for amplified vocals and beats, Classic for a more dynamic range in orchestral music, and Jazz for smooth and detailed sound.
- 7.** The LED screen interface supports 18 different languages, allowing for a personalized and user-friendly experience across global users.

Product Overview

A. Headset

1. ⊕ Volume Up/Next Song
2. ⏻ Power On/Off, Music Play/Pause
3. ⊖ Volume Down/Previous Song
4. Calling Microphone
5. LCD Touchscreen
6. Communication Pin
7. 3.5mm AUX Jack Port
8. Type-C Charging Port
9. Charging Indicator
10. ANC Button

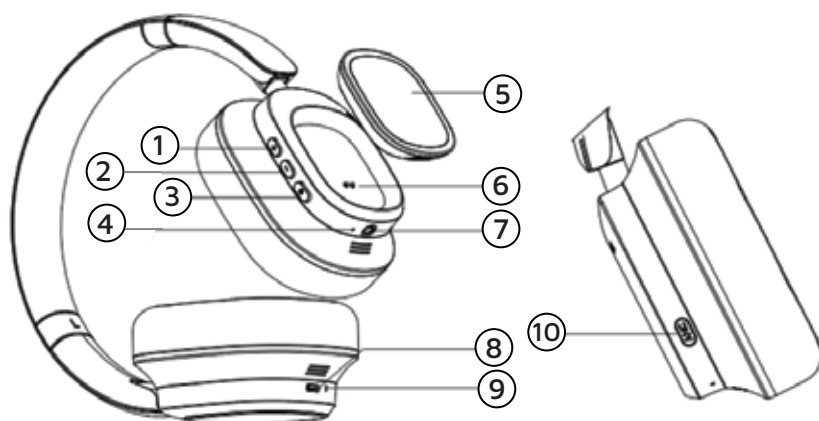

B. Touchscreen

1. Type-C charging port
2. Power button
3. Communication pin

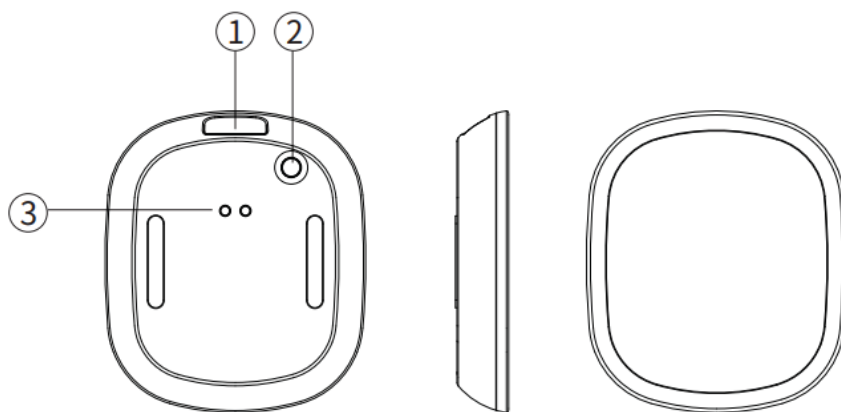

Power ON/OFF Instructions

A. Headset

A.1 Power ON

In power-off mode, press and hold the power button for approximately 2 seconds. The indicator will flash blue and red alternately until you hear the voice prompt "Power ON," after which the headset enters pairing mode with the voice announcement "pairing."

A.2 Power OFF

In power-on mode, press and hold the power button for around 4 seconds. The indicator will then turn off.

B. Touchscreen

B.1 Power ON

In power-off mode, press the power button.

B.2 Power OFF

In power-on mode, press and hold the power button for approximately 4 seconds.

B.3 Screen Timeout Settings

1. After powering on, the screen will automatically turn off if there is no activity within 30 seconds.
2. In power-on mode, the screen will automatically turn off when the headset is stored and will turn on when it is removed.
3. In power-on mode, the screen will turn off if you click the power button and will reactivate if you press the power button again.

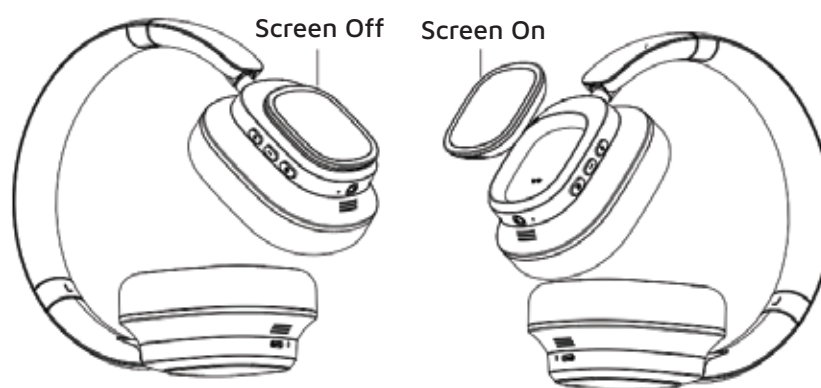

Pairing Screen with Headset

1. Turn on both the headset and the screen.
2. Attach the screen to the headset.
3. Triple-click the power button of the headset.
4. Upon successful connection, the Bluetooth icon on the screen will turn white.

Note:

1. If the connection is unsuccessful, the Bluetooth icon on the screen will turn red.
2. If the connection fails, please attempt to connect again by triple- clicking the power button.

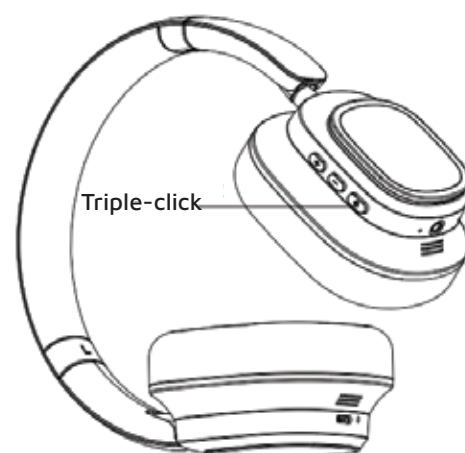

Pairing Headset with Devices

1. Upon powering on, the device will indicate its readiness to pair by emitting a flashing blue and red lights.
2. Activate the Bluetooth function on your mobile or another device, locate the pairing name " LVL-VibeMaster" in the available devices list, and connect.
3. A successful connection is confirmed by a voice prompt "Connected" ,followed by the blue indicator light flashing every 5 seconds.

Headset Button Guide

A. Music Playback Controls

Volume Up: Briefly press the  button.

Volume Down: Briefly press the  button.

Next Song: Press and hold the  button.

Previous Song: Press and hold the  button.

Music Play/Pause: Press the power button  .

B. Call Management

Answer Call: Press the power button  to answer an incoming call.

End Call: Press the power button  to end the call.

Reject Call: Press and hold the power button  for about 2 seconds.

Redial: Double press the power button  to redial the last called number.

C. Siri Function

Activate Siri by pressing and holding the power button  for approximately 1 second.

D. Clear Pairing

In power-on mode, press the power button  four times until the blue and red indicators flash alternately.

Headset ANC Mode

The default setting is normal mode. Press the ANC button  to activate ANC mode. Press the ANC button again to switch to transparency mode.

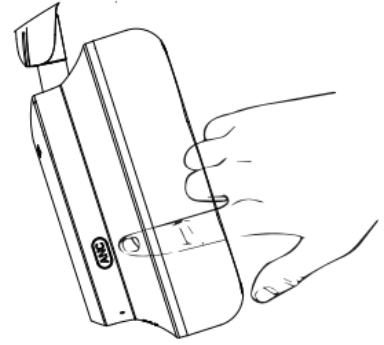

Headset AUX Mode

Connect the AUX cable to both the headset and a mobile device or other devices such as a computer or iPad to play music.

Note:

1. When you insert the AUX cable into the headset, it will automatically turn off. Remove the AUX cable if you need to turn on the headset.
2. The ANC (Active Noise Cancelling) mode does not function when the headset is powered off.

Touchscreen Operation Guide

Music Play: Control playback, skip songs, pause music, and display lyrics.

Volume Adjustment: Increase or decrease volume.

ANC Mode: Choose between ANC mode, normal mode, and transparency mode.

EQ Adjustment: Select from five EQ settings: Normal, Rock, Pop, Classic, and Jazz.

Alarm: Set user-defined alarms.

Screen Brightness: Adjust the brightness level.

Language Selection: Choose from 18 available languages.

Lock Screen Wallpaper: Customize the lock screen wallpaper.

Light: Toggle the light on or off by touching the screen.

Date & Time Setting: Set the date and time to user preference.

Take Photos: Connect the headset to a mobile device via Bluetooth and control the mobile's camera to take photos.

Give a Like: Connect the headset to a mobile device, play videos on the app, and give likes directly from the interface.

Headset Indicator Light Guide

Successful Connection	The blue indicator blinks every 5 seconds.
Pairing Status	The red and blue indicators blink alternately.
Reset	The blue indicator blinks every 5 seconds.
Listen to Music	The indicator will be a solid blue.
Fully Charged	The indicator will be a solid green.
ANC ON	The red indicator will go off.
Power OFF	The indicator will be a solid red.
Charging	The blue indicator blinks every 5 seconds.

Charging

A. Headset

1. While charging, the indicator light will be a solid red.

2. Once charging is complete, the indicator light will turn solid blue.

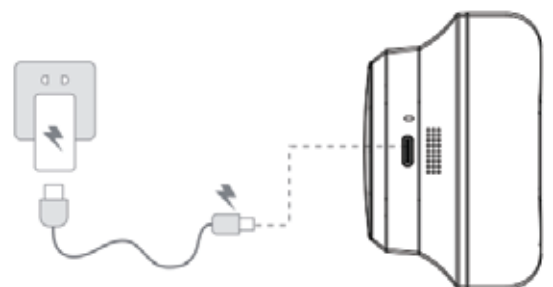

B. Touchscreen

Connect the screen to the adapter using a Type-C charging cable.
Note: Ensure the correct orientation when connecting the screen to the headset.

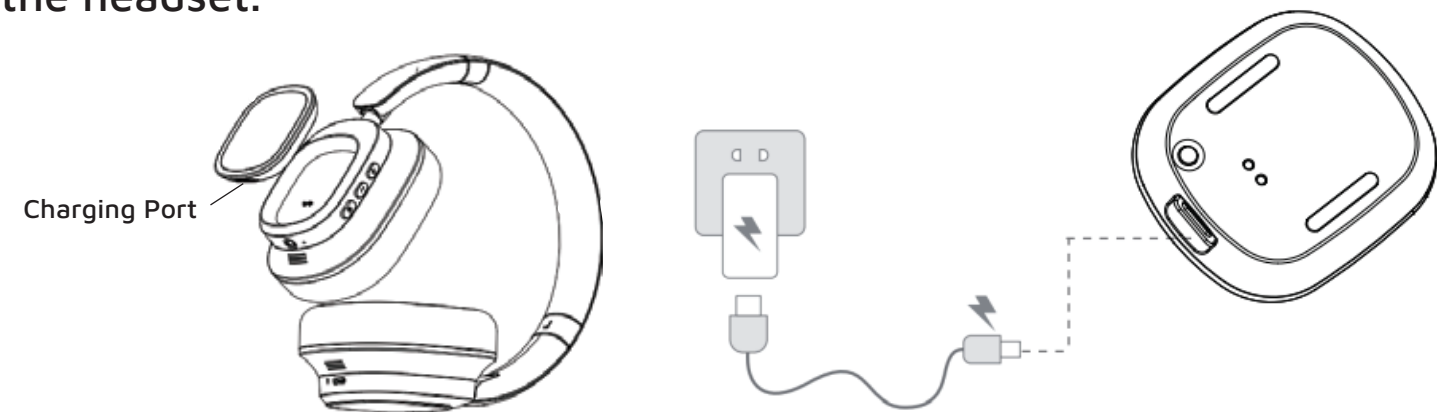

Specifications

Product Name	Levelo VibeMaster Hybrid ANC Headphone
SKU	LVLVMAHPBK
Headset	
Bluetooth Chipset	JL7018, V5.3
Bluetooth Name	LVL-VibeMaster
Bluetooth Range	10m
Frequency Response	20Hz-20KHz
Battery	600mAh Li-ion
Input	DC 5V/1A
Charging Time	2h
Music Playing Time	25h (ANC ON) with 100 % Volume 40h (ANC OFF) with 100 % Volume

Impedance	Φ40mm 32Ω±10 %
Sensitivity	106±3dB
Charging Port	Type-C
Touchscreen	
Bluetooth Chipset	JL7012, V5.3
Bluetooth Range	10m
Battery	200mAh Li-ion
Input	DC 5V/1A
Charging Time	1.5h
Charging Port	Type-C

Warranty

Products procured directly from the **Levelo** website or physical store comes with a 24-month warranty. **Levelo** products purchased from any of our authorized dealers are guaranteed with a one-year warranty. If you wish to extend this warranty, you'll need to go to our website at **<https://levelobrand.com/warranty>** and fill out the necessary form, making sure to include your personal information and a photo of the product. After your request has been evaluated and accepted, we'll send you an email notification to affirm the extension of your product's warranty.

For more info, please check:

Website: **<https://www.levelobrand.com/warranty>**

Contact Us

If you have any questions about this Privacy Policy, please contact us at: **Info@levelobrand.com**

Website: **<https://www.levelobrand.com/>**

Email: **Info@levelobrand.com**

Instagram: **levelobrand**

Facebook: **levelobrand**